



Duct Type Electric-Heater DTH

**DESCRIPTION:**

GMCAIR duct type electric heaters are used to heat the fresh air or to reheat the supply air in ventilation systems. Moreover, it is used to increase the supply air temperature with heat recovery units. All Electric Heaters have CE marked in compliance with applicable directives. GMCAIR electric duct heaters are classified as DTH195 and DTH295 models. DTH295 models are circular electric duct heaters and produced at a dimension of standard spiral duct diameter. DTH195 models are rectangular electric duct heaters and produced with the dimensions as required. GMCAIR DTH395 type electrical heaters, are designed for air handling units and they can be installed easily inside the air handling units. They are used to heat the outdoor air or reheat the supply air in the air handling units.

MATERIAL :

Frame made of Galvanized Sheet Metal

FUNCTION :

- All duct type electrical heaters can be connected to the duct system without and accessory.
- Heating elements are made of stainless steel.
- The casing is made of galvanised steel sheet or stainless steel up on request.

INSTALLATION :

- Screw

STANDARD SIZES (mm):

AVAILABLE SIZES (mm) - Always width x height												
HEIGHT	WIDHT											
	200	300	400	500	600	800	1000	1200	1400	1600	1800	2000
200	X	X	X	X	X	X	X	X	X	X	X	X
250	X	X	X	X	X	X	X	X	X	X	X	X
300	X	X	X	X	X	X	X	X	X	X	X	X
350	X	X	X	X	X	X	X	X	X	X	X	X
400	X	X	X	X	X	X	X	X	X	X	X	X
450	X	X	X	X	X	X	X	X	X	X	X	X
500	X	X	X	X	X	X	X	X	X	X	X	X
600	X	X	X	X	X	X	X	X	X	X	X	X
700	X	X	X	X	X	X	X	X	X	X	X	X
800	X	X	X	X	X	X	X	X	X	X	X	X
900	X	X	X	X	X	X	X	X	X	X	X	X
1000	X	X	X	X	X	X	X	X	X	X	X	X
1100	X	X	X	X	X	X	X	X	X	X	X	X
1300	X	X	X	X	X	X	X	X	X	X	X	X
1400	X	X	X	X	X	X	X	X	X	X	X	X
1500	X	X	X	X	X	X	X	X	X	X	X	X
2000	X	X	X	X	X	X	X	X	X	X	X	X

DRAWING

Rectangular Duct Type Electrical Heaters-DTH195

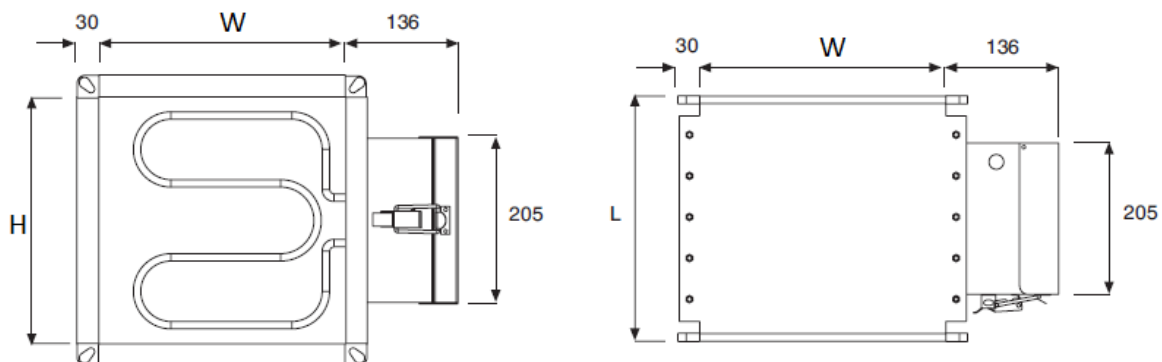

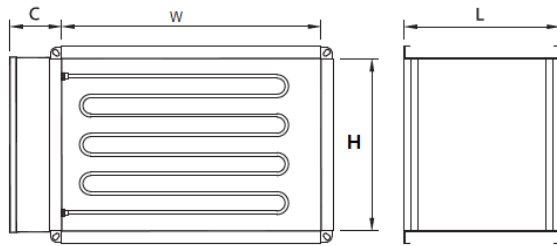

W : Min: 200 mm / Max: 2000 mm

H : Min: 200 mm / Max: 2000 mm

L : 360 mm Standard Min: 200 mm / Max. 500 mm

C : 120 mm Standard / 200 mm With control equipment

Air Handling Unit Type Electrical Heater

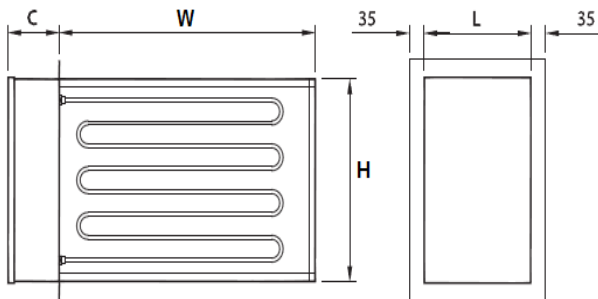

W : Min: 200 mm / Max: 2000 mm

H : Min: 200 mm / Max: 2000 mm

L : 360 mm Standard Min: 200 mm / Max. 500 mm

C : 120 mm Standard / 200 mm With control equipment

Circular Duct Type Electrical Heater-DTH295

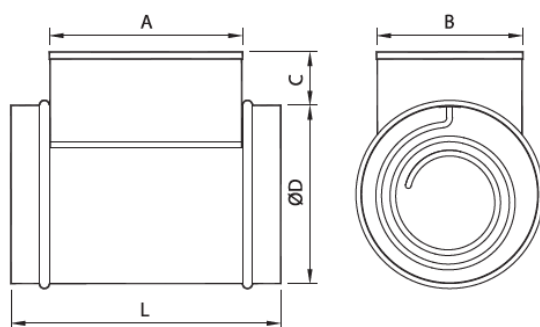

Ød: Min. 100 mm Max. 450 mm

L : 380 mm Standard / 500 mm With control equipment

A : 275 mm (min.)

B : 200 mm

C : 75 mm Standard / 110 mm With control equipment



SELECTION TABLES

Recommended Capacities

Capacity Range		Electrical Connection
0,5 ~ 3,0	kW	230 Volt, 1 ~
3,1 ~ 6,0	kW	400 Volt, 2 ~
6,1 ~	kW	400 Volt, 3 ~

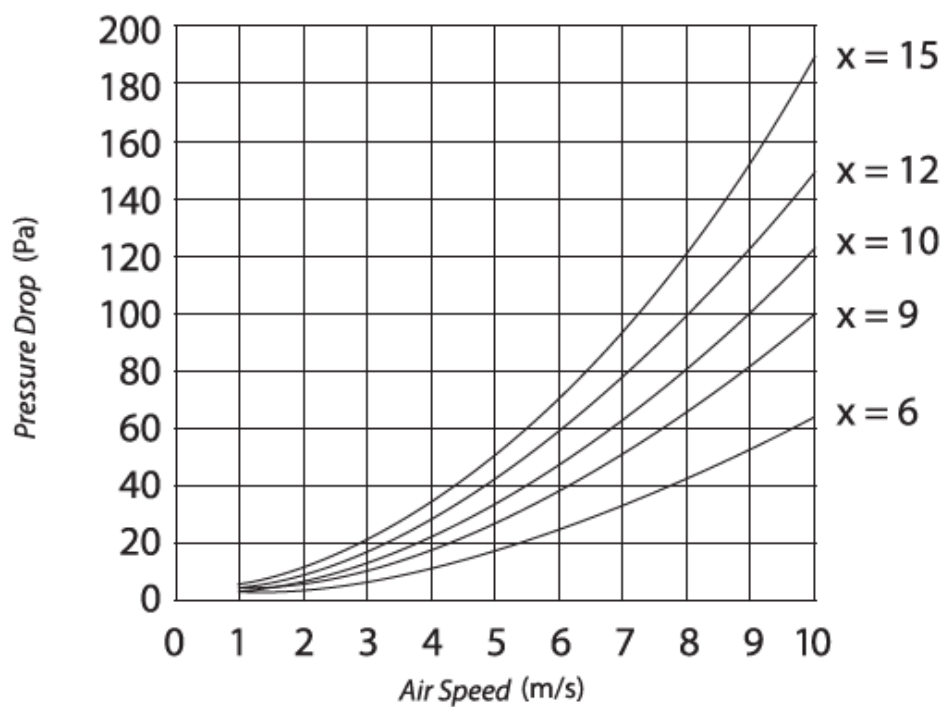
PRESSURE DROP CALCULATION

$$X = \frac{P}{S \times 15}$$

X: No of heating elements

P: Total Power [kW]

S: Duct heater cross section

[m²], S = A x B



ORDER CODE

DTH-195	-	GA
DTH-195: Prismatic Model DTH-295: Circular Model		SS: Stainless Steel GA: Galvanised
- Standard Application		